

Old Admin Bldg (Board of Ed)  
263 McCaul Street

Building code: OA



Photo 1 - Building

Photo 2 - Main Entrance facing Service Lot

|  |      |
|--|------|
| Number of Building entrances           | 3    |
| Number of Entrances with Power Openers | 1    |
| Floors accessible via elevator         | all  |
| Floors with accessible washrooms       | none |

Main Entrance





|  |      |
|--|------|
| Side of building with main entrance          | West |
| Does this entrance have a power door opener? | No   |
| Is this entrance visible from the street?    | No   |
| Type of Pathway leading to entrance          | Path |

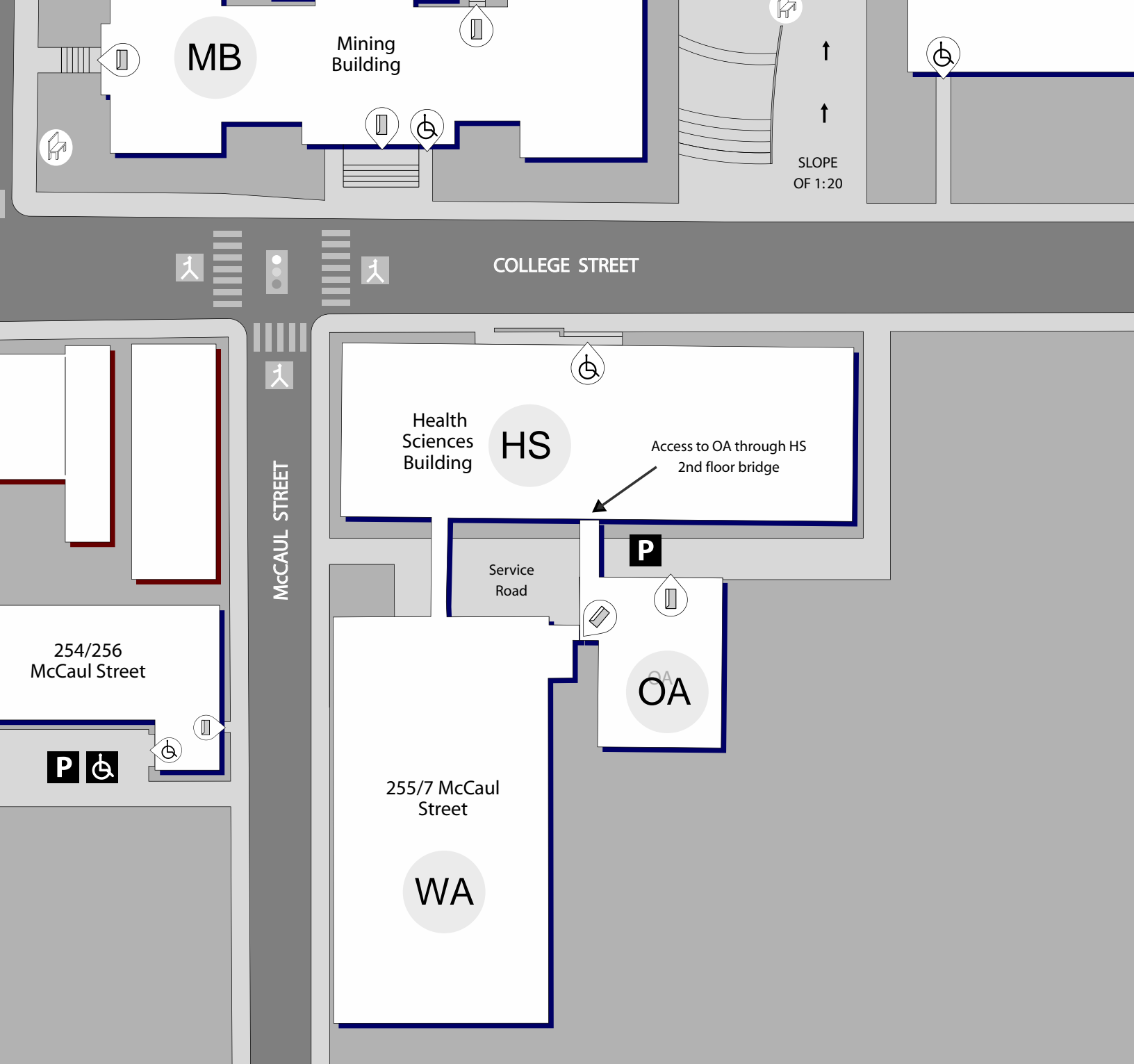

Secondary Entrance

|  |       |
|--|-------|
| Side of building with secondary entrance     | North |
| Does this entrance have a power door opener? | Yes   |
| Is this entrance visible from the street?    | Yes   |
| Type of Pathway leading to entrance          |       |

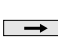
A secondary entrance, via raised bridge from the Health Sciences Building, has automated doors.



-  Entrance
-  Entrance with Auto Door Opener
-  Sidewalk
-  Ramp: arrow indicates up
-  Stair
-  Rest Area

-  Vehicle Traffic Lights
-  Stop Signs
-  Pedestrian Crossing Lines
-  Flashing Pedestrian Signal
-  Button for Pedestrian Crossing
-  Audio Crossing Signal

-  Parking
-  Reserved Parking

